

Aluminium Ex

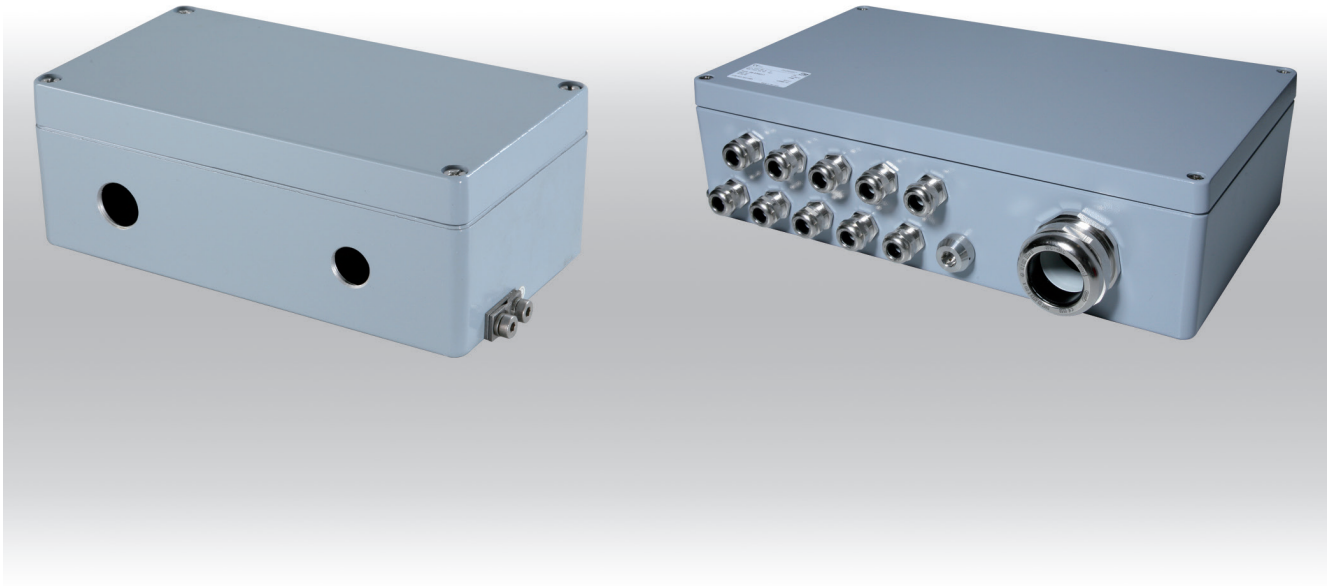

- + Enclosure systems of diecast aluminium usable in all Ex-areas
- + Empty enclosures with U-approval for individual fittings or Ex eb / Ex ia junction box
- + Optional version with window
- + Temperature classes T6 / T5 / T4

Included in delivery

Empty enclosure: Enclosure with silicone seal and external earth connection.
 Junction box: Enclosure system - depending on version either with silicone seal, external earthing, DIN rails, internal earthing connection, terminals, manufacturing, cable glands

Technical datas

Explosion protection	II 2G Ex eb IIC T6/T5/T4 Gb II 2G Ex ia IIC T6/T5/T4 Gb II 2G Ex db eb ia [ia] mb IIC T6/T5/T4 Gb II 3 G Ex eb db mb ia [ia Ga] nA nC [op is] IIC T6, T5, T4 Gc II 2D Ex tb IIIC T85°C/T100°C/T135°C Db IP66
Certificates	PTB 00 ATEX 1063 IECEx PTB 08.0006 EAC RU C-DE.AA87.B.00637
Material	DIN EN 1706 EN AC-AISI 12 (Fe)
Colour	Powder coating, RAL 7001, silver grey
Ingress protection	IP66 to EN 60529
Impact resistance	7 Joule to EN 60079-0
Temperature range	-55 °C to +135 °C
Other execution on request	EMC, SBG, SBGL, SWB



Aluminium Ex

Product overview

Ex e		Ex Empty		Ex i		Dimensions H x W x D (mm)	Weight (g)
Order no.	Product type	Order no.	Product type	Order no.	Product type		
05.06 06 03	AExe 05010	25.06 06 03	AExB 25010	15.06 06 03	AExi 15010	64 x 58 x 34	160
05.06 10 03	AExe 05015	25.06 10 03	AExB 25015	15.06 10 03	AExi 15015	64 x 98 x 34	220
05.06 15 03	AExe 05020	25.06 15 03	AExB 25020	15.06 15 03	AExi 15020	64 x 150 x 34	360
05.08 08 06	AExe 05025	25.08 08 06	AExB 25025	15.08 08 06	AExi 15025	80 x 75 x 57	300
05.08 13 06	AExe 05030	25.08 13 06	AExB 25030	15.08 13 06	AExi 15030	80 x 125 x 57	375
05.08 18 06	AExe 05035	25.08 18 06	AExB 25035	15.08 18 06	AExi 15035	80 x 175 x 57	550
05.08 25 05	AExe 05040	25.08 25 05	AExB 25040	15.08 25 05	AExi 15040	80 x 250 x 52	730
05.10 10 08	AExe 05045	25.10 10 08	AExB 25045	15.10 10 08	AExi 15045	100 x 100 x 81	620
05.10 16 08	AExe 05050	25.10 16 08	AExB 25050	15.10 16 08	AExi 15050	100 x 160 x 81	820
05.10 20 08	AExe 05055	25.10 20 08	AExB 25055	15.10 20 08	AExi 15055	100 x 200 x 81	970
05.12 12 08	AExe 05060	25.12 12 08	AExe 05010	15.12 12 08	AExi 15060	120 x 122 x 81	940
05.12 12 09	AExe 05065	25.12 12 09	AExe 05015	15.12 12 09	AExi 15065	120 x 122 x 91	960
05.12 22 08	AExe 05070	25.12 22 08	AExe 05020	15.12 22 08	AExi 15070	120 x 220 x 81	1410
05.12 22 09	AExe 05075	25.12 22 09	AExe 05025	15.12 22 09	AExi 15075	120 x 220 x 91	1430
05.12 36 08	AExe 05080	25.12 36 08	AExe 05030	15.12 36 08	AExi 15080	120 x 360 x 81	1970
05.14 14 09	AExe 05085	25.14 14 09	AExe 05035	15.14 14 09	AExi 15085	140 x 140 x 91	1520
05.14 20 09	AExe 05090	25.14 20 09	AExe 05040	15.14 20 09	AExi 15090	140 x 200 x 91	2270
05.16 16 09	AExe 05095	25.16 16 09	AExe 05045	15.16 16 09	AExi 15095	160 x 160 x 91	1500
05.16 26 09	AExe 05100	25.16 26 09	AExe 05050	15.16 26 09	AExi 15100	160 x 260 x 91	2030
05.16 36 09	AExe 05105	25.16 36 09	AExe 05055	15.16 36 09	AExi 15105	160 x 360 x 91	2540
05.16 56 09	AExe 05110	25.16 56 09	AExe 05060	15.16 56 09	AExi 15110	160 x 560 x 91	3760
05.18 18 10	AExe 05115	25.18 18 10	AExe 05065	15.18 18 10	AExi 15115	180 x 180 x 101	2270
05.18 28 10	AExe 05120	25.18 28 10	AExe 05070	15.23 10 11	AExi 15120	180 x 280 x 101	2920
05.23 10 11	AExe 05125	25.23 10 11	AExe 05075	15.18 28 10	AExi 15125	230 x 100 x 111	1800
05.23 20 11	AExe 05130	25.23 20 11	AExe 05080	15.23 20 11	AExi 15130	232 x 202 x 111	2440
05.23 20 18	AExe 05135	25.23 20 18	AExe 05085	15.23 20 18	AExi 15135	232 x 202 x 181	3980
05.23 28 11	AExe 05140	25.23 28 11	AExe 05090	15.23 28 11	AExi 15140	230 x 280 x 111	2990
05.23 33 11	AExe 05145	25.23 33 11	AExe 05095	15.23 33 11	AExi 15145	230 x 330 x 111	3390
05.23 33 18	AExe 05150	25.23 33 18	AExe 05100	15.23 33 18	AExi 15150	230 x 330 x 181	5260
05.23 40 11	AExe 05155	25.23 40 11	AExe 05105	15.23 40 11	AExi 15155	230 x 400 x 111	3840
05.23 40 23	AExe 05160	25.23 40 23	AExe 05110	15.23 40 23	AExi 15160	230 x 400 x 225	6840
05.23 60 11	AExe 05165	25.23 60 11	AExe 05115	15.23 60 11	AExi 15165	230 x 600 x 111	6950
05.31 40 11	AExe 05170	25.31 40 11	AExe 05120	15.31 40 11	AExi 15170	313 x 404 x 111	5300
05.31 40 14	AExe 05175	25.31 40 14	AExe 05125	15.31 40 14	AExi 15175	312 x 403 x 141	6720
05.31 40 18	AExe 05180	25.31 40 18	AExe 05130	15.31 40 18	AExi 15180	313 x 404 x 181	8480
05.31 40 23	AExe 05185	25.31 40 23	AExe 05135	15.31 40 23	AExi 15185	313 x 404 x 227	8680
05.31 60 11	AExe 05190	25.31 60 11	AExe 05140	15.31 60 11	AExi 15190	310 x 600 x 111	8660
05.31 60 18	AExe 05195	25.31 60 18	AExe 05145	15.31 60 18	AExi 15195	310 x 600 x 181	11100
05.60 60 20	AExe 05200	25.60 60 20	AExe 05150	15.60 60 20	AExi 15200	600 x 600 x 202	25960



Aluminium Ex

Accessories

Order no.	DIN rails	External mounting brackets	Mounting plate
XX.06 06 03			
XX.06 10 03	•		
XX.06 15 03	•		
XX.08 08 06	•	•	•
XX.08 13 06	•	•	•
XX.08 18 06	•	•	•
XX.08 25 05	•	•	
XX.10 10 08	•	•	•
XX.10 16 08	•	•	•
XX.10 20 08	•	•	•
XX.12 12 08	•	•	•
XX.12 12 09	•	•	•
XX.12 22 08	•	•	•
XX.12 22 09	•	•	•
XX.12 36 08	•	•	•
XX.14 14 09	•	•	•
XX.14 20 09	•	•	•
XX.16 16 09	•	•	•
XX.16 26 09	•	•	•
XX.16 36 09	•	•	•
XX.16 56 09	•	•	•
XX.18 18 10	•	•	•
XX.18 28 10	•	•	•
XX.23 10 11	•	•	•
XX.23 20 11	•	•	•
XX.23 20 18	•	•	•
XX.23 28 11	•	•	•
XX.23 33 11	•	•	•
XX.23 33 18	•	•	•
XX.23 40 11	•	•	•
XX.23 40 23	•	•	•
XX.23 60 11	•	•	•
XX.31 40 11	•	•	•
XX.31 40 14	•	•	•
XX.31 40 18	•	•	•
XX.31 40 23	•	•	•
XX.31 60 11	•	•	•
XX.31 60 18	•	•	•
XX.60 60 20	•		•



Aluminium Ex

Accessories

Allen lid screws

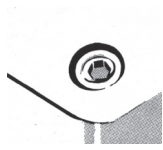

Order no.	Version
12.01 80 02	for XX.06 06 03 up to XX.10 20 08
12.01 80 04	for XX.12 12 08 up to XX.31 40 23

DIN rails

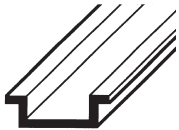

Order no.	Version
10.06 10 07	TS 15 for XX.06 10 03
10.06 10 02	TS 15 for XX.06 15 03
10.06 10 03	TS 15 for XX.08 08 06
10.06 10 04	TS 15 for XX.08 13 06
10.06 10 05	TS 15 for XX.08 18 06
10.06 10 06	TS 15 for XX.08 25 05
10.06 10 08	TS 15 for XX.10 16 08
10.06 10 09	TS 15 for XX.10 20 08
10.06 14 21	TS 35/7.5 for XX.12 12 08, XX.12 12 09
10.06 14 22	TS 35/7.5 for XX.12 22 08, XX.12 22 09, XX.12 22 12
10.06 14 25	TS 35/7.5 for XX.12 36 08
10.06 14 54	TS 35/7.5 for XX.14 14 09
10.06 14 55	TS 35/7.5 for XX.14 20 09
10.06 14 23	TS 35/7.5 for XX.16 16 09
10.06 14 24	TS 35/7.5 for XX.16 26 09, XX.16 26 16
10.06 14 26	TS 35/7.5 for XX.16 56 09
10.06 14 56	TS 35/7.5 for XX.18 18 10
10.06 14 57	TS 35/7.5 for XX.18 28 10
10.06 14 29	TS 35/7.5 for XX.23 10 11
10.06 14 30	TS 35/7.5 for XX.23 20 11, XX.23 20 18
10.06 14 31	TS 35/7.5 for XX.23 28 11
10.06 14 32	TS 35/7.5 for XX.23 33 11, XX.23 33 18
10.06 14 27	TS 35/7.5 for XX.23 40 11, XX.23 40 23, XX.31 40 11, XX.31 40 14, XX.31 40 18, XX.31 40 23
10.06 14 28	TS 35/7.5 for XX.23 60 11, XX.31 60 11, XX.31 60 18
10.06 14 33	TS 35/7.5 for XX.60 60 20

External hinges

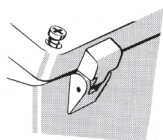

Swivelling range 150°,
set = 2 pcs

Order no.
10.02 70 01

External mounting brackets

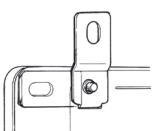

set = 4 pcs

Order no.	Version
10.03 11 01	for XX.08 08 06 - XX.10 20 08
10.03 11 02	for XX.12 12 08 - XX.31 60 18, XX.14 01 00 - XX.14 03 00



Aluminium Ex

Accessories

Internal hinges



swivelling range 95°,
set = 2 pcs

Order no.

10.02 20 01

Lead-sealing screw

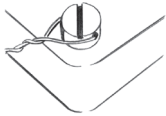

Order no.

12.01 90 01

Version

for XX.05 05 03 - XX.10 20 08

Mounting plate

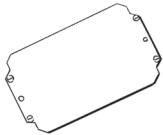

Order no.

10.01 10 01

Version

for XX.08 08 06

10.01 10 03

for XX.08 13 06

10.01 10 05

for XX.08 18 06

10.01 10 24

for XX.10 10 08

10.01 10 25

for XX.10 16 08

10.01 10 26

for XX.10 20 08

10.01 10 07

for XX.12 12 08, XX.12 12 09

10.01 10 08

for XX.12 22 08, XX.12 22 09

10.01 10 09

for XX.12 36 08

10.01 10 27

for XX.14 14 09

10.01 10 28

for XX.14 20 09

10.01 10 10

for XX.16 16 09

10.01 10 11

for XX.16 26 09

10.01 10 12

for XX.16 36 09

10.01 10 13

for XX.16 56 09

10.01 10 29

for XX.18 18 10

10.01 10 30

for XX.18 28 10

10.01 10 14

for XX.23 10 11

10.01 10 15

for XX.23 20 11, XX.23 20 18

10.01 10 16

for XX.23 28 11

10.01 10 17

for XX.23 33 11, XX.23 33 18

10.01 10 18

for XX.23 40 11, XX.23 40 23

10.01 10 19

for XX.23 60 11

10.01 10 20

for XX.31 40 11, XX.31 40 14, XX.31 40 18, XX.31 40 23

10.01 10 21

for XX.31 60 11, XX.31 60 18

10.01 10 22

for XX.60 60 20



Aluminium Ex

Accessories

PE bar



Order no.	Version
12.05 42 16	for XX.14 14 09
12.05 42 17	for XX.14 20 09, XX.23 20 11, XX.23 20 18
12.05 42 18	for XX.16 16 09
12.05 42 19	for XX.16 26 09
12.05 42 20	for XX.16 36 09
12.05 42 21	for XX.16 56 09
12.05 42 22	for XX.18 18 10
12.05 42 23	for XX.18 28 10, XX.23 28 11
12.05 42 24	for XX.23 10 11
12.05 42 28	for XX.23 33 11, XX.23 33 18
12.05 42 30	for XX.23 40 11, XX.23 40 23, XX.31 40 11, XX.31 40 14, XX.31 40 18, XX.31 40 23
12.05 42 32	for XX.23 60 11, XX.31 60 11, XX.31 60 18

PE busbar

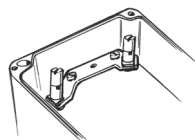

Order no.	Version
12.05 30 01	for XX.08 08 06 up to XX.08 18 06
12.05 30 02	for XX.12 12 08 up to XX.12 36 08

sealable screw



Order no.	Version
12.01 90 02	for XX.12 12 08 - XX.31 60 18

Aluminium Ex

Technical details



Order no.	Product type	Dimensions H x W x D (mm)
05.06 06 03	AExe 05010	64 x 58 x 34
15.06 06 03	AExi 15010	64 x 58 x 34
25.06 06 03	AExB 25010	64 x 58 x 34

Maximum number of cable glands



	1,5	2,5	4	6	10	16	25	35	50	70	95
	3	3									
x A	6										
	10	18									
	16	6	12								
	20	2	7								
	25		3								
	35										
	50										
	63										
	80										
	100										
	125										
	160										
	200										
	225										
	250										
	315										
400											
500											

M	Side	
	A/B	C/D
12	2	1
16		
20		
25		
32		
40		
50		
63		
75		
85		



Order no.	Product type	Dimensions H x W x D (mm)
05.06 10 03	AExe 05015	64 x 98 x 34
15.06 10 03	AExi 15015	64 x 98 x 34
25.06 10 03	AExB 25015	64 x 98 x 34

Maximum number of cable glands



	1,5	2,5	4	6	10	16	25	35	50	70	95
	6	6									
	1	1									
x A	6										
	10	20									
	16	7	13								
	20	2	7								
	25		3								
	35										
	50										
	63										
	80										
	100										
	125										
	160										
	200										
	225										
	250										
	315										
400											
500											

M	Side	
	A/B	C/D
12	4	1
16		
20		
25		
32		
40		
50		
63		
75		
85		

DIN rail	TS 15
Length (mm)	87,5
External earth (mm ²)	2,5



Aluminium Ex

Technical details



Order no.	Product type	Dimensions H x W x D (mm)
05.06 15 03	AExe 05020	64 x 150 x 34
15.06 15 03	AExi 15020	64 x 150 x 34
25.06 15 03	AExB 25020	64 x 150 x 34

	1,5	2,5	4	6	10	16	25	35	50	70	95
		10	10								
	1	1									
 x A	6										
	10	20									
	16	7	13								
	20	3	8								
	25		3								
	35										
	50										
	63										
	80										
	100										
	125										
	160										
	200										
	225										
	250										
	315										
400											
500											

Maximum number of cable glands

M	Side	
	A/B	C/D
12	8	1
16		
20		
25		
32		
40		
50		
63		
75		
85		

DIN rail	TS 15
Length (mm)	139
External earth (mm ²)	2,5



Order no.	Product type	Dimensions H x W x D (mm)
05.08 08 06	AExe 05025	80 x 75 x 57
15.08 08 06	AExi 15025	80 x 75 x 57
25.08 08 06	AExB 25025	80 x 75 x 57

	1,5	2,5	4	6	10	16	25	35	50	70	95
		6	6	5							
	1	1	1								
 x A	6										
	10	27									
	16	9	18	70							
	20	3	10	20							
	25		5	11							
	35			3							
	50										
	63										
	80										
	100										
	125										
	160										
	200										
	225										
	250										
	315										
400											
500											

Maximum number of cable glands

M	Side	
	A/B	C/D
12	3	5
16	1	2
20	1	2
25	1	1
32		
40		
50		
63		
75		
85		

DIN rail	TS 15
Length (mm)	63
max. fitting length (mm)	46
External earth (mm ²)	4



Aluminium Ex

Technical details



Order no.	Product type	Dimensions H x W x D (mm)
05.08 13 06	AExe 05030	80 x 125 x 57
15.08 13 06	AExi 15030	80 x 125 x 57
25.08 13 06	AExB 25030	80 x 125 x 57

Terminal type	1,5	2,5	4	6	10	16	25	35	50	70	95
	12	12	9								
	1	1	1								
x N A	6										
	10	29									
	16	10	19	76							
	20	4	11	22							
	25		5	12							
	35			3							
	50										
	63										
	80										
	100										
	125										
	160										
	200										
	225										
	250										
	315										
	400										
500											

Maximum number of cable glands

M	Side	
	A/B	C/D
12	9	5
16	4	2
20	3	2
25	2	1
32		
40		
50		
63		
75		
85		

DIN rail	TS 15
Length (mm)	113
max. fitting length (mm)	85,5
External earth (mm ²)	4



Order no.	Product type	Dimensions H x W x D (mm)
05.08 18 06	AExe 05035	80 x 175 x 57
15.08 18 06	AExi 15035	80 x 175 x 57
25.08 18 06	AExB 25035	80 x 175 x 57

Terminal type	1,5	2,5	4	6	10	16	25	35	50	70	95
	25	25	21								
	1	1	1								
x N A	6										
	10	29									
	16	10	19	77							
	20	4	11	22							
	25		5	12							
	35			3							
	50										
	63										
	80										
	100										
	125										
	160										
	200										
	225										
	250										
	315										
	400										
500											

Maximum number of cable glands

M	Side	
	A/B	C/D
12	14	5
16	6	2
20	5	2
25	3	1
32		
40		
50		
63		
75		
85		

DIN rail	TS 15
Length (mm)	163
max. fitting length (mm)	135,5
External earth (mm ²)	4



Aluminium Ex

Technical details



Order no.	Product type	Dimensions H x W x D (mm)
05.08 25 05	AExe 05040	80 x 250 x 52
15.08 25 05	AExi 15040	80 x 250 x 52
25.08 25 05	AExB 25040	80 x 250 x 52

		1,5	2,5	4	6	10	16	25	35	50	70	95
		40	40	33								
	N	1	1	1								
x A	6											
	10	28										
	16	9	19	73								
	20	4	11	21								
	25		5	12								
	35			3								
	50											
	63											
	80											
	100											
	125											
	160											
	200											
	225											
	250											
	315											
400												
500												

Maximum number of cable glands

M	Side	
	A/B	C/D
12	23	6
16	9	2
20	8	2
25	5	1
32		
40		
50		
63		
75		
85		

DIN rail	TS 15
Length (mm)	238
max. fitting length (mm)	209,5
External earth (mm ²)	4



Order no.	Product type	Dimensions H x W x D (mm)
05.10 10 08	AExe 05045	100 x 100 x 81
15.10 10 08	AExi 15045	100 x 100 x 81
25.10 10 08	AExB 25045	100 x 100 x 81

		1,5	2,5	4	6	10	16	25	35	50	70	95
		14	11	9	7							
	N	1	1	1	1							
x A	6											
	10	37										
	16	12	24	95								
	20	5	14	27								
	25		6	15	30							
	35			4	11							
	50											
	63											
	80											
	100											
	125											
	160											
	200											
	225											
	250											
	315											
400												
500												

Maximum number of cable glands

M	Side	
	A/B	C/D
12	12	9
16	6	4
20	5	3
25	2	1
32	1	1
40		
50		
63		
75		
85		

DIN rail	TS 15/35
Length (mm)	87,5
max. fitting length (mm)	59,5
External earth (mm ²)	6



Aluminium Ex

Technical details



Order no.	Product type	Dimensions H x W x D (mm)
05.10 16 08	AExe 05050	100 x 160 x 81
15.10 16 08	AExi 15050	100 x 160 x 81
25.10 16 08	AExB 25050	100 x 160 x 81

		1,5	2,5	4	6	10	16	25	35	50	70	95
		28	23	19	14							
		1	1	1	1							
x A	6											
	10	39										
	16	13	26	101								
	20	5	15	29								
	25		7	16	32							
	35			4	12							
	50											
	63											
	80											
	100											
	125											
	160											
	200											
	225											
	250											
	315											
400												
500												

Maximum number of cable glands

M	Side	
	A/B	C/D
12	24	9
16	11	4
20	10	3
25	4	1
32	3	1
40		
50		
63		
75		
85		

DIN rail	TS 15/35
Length (mm)	148
max. fitting length (mm)	120
External earth (mm ²)	6



Order no.	Product type	Dimensions H x W x D (mm)
05.10 20 08	AExe 05055	100 x 200 x 81
15.10 20 08	AExi 15055	100 x 200 x 81
25.10 20 08	AExB 25055	100 x 200 x 81

		1,5	2,5	4	6	10	16	25	35	50	70	95
		38	30	25	19							
		1	1	1	1							
x A	6											
	10	39										
	16	13	26	102								
	20	5	15	29								
	25		7	16	32							
	35			5	12							
	50											
	63											
	80											
	100											
	125											
	160											
	200											
	225											
	250											
	315											
400												
500												

Maximum number of cable glands

M	Side	
	A/B	C/D
12	32	9
16	14	4
20	12	3
25	5	1
32	3	1
40		
50		
63		
75		
85		

DIN rail	TS 15/35
Length (mm)	188
max. fitting length (mm)	160
External earth (mm ²)	6



Aluminium Ex

Technical details



Order no.	Product type	Dimensions H x W x D (mm)
05.12 12 08	AExe 05060	120 x 122 x 81
15.12 12 08	AExi 15060	120 x 122 x 81
25.12 12 08	AExe 05010	120 x 122 x 81

		1,5	2,5	4	6	10	16	25	35	50	70	95
		19	15	13	10	8	6					
		1	1	1	1	1	1					
x 	6											
	10	40										
	16	13	26	103								
	20	5	15	30								
	25		7	17	32							
	35			5	12	31						
	50					10	26					
	63					3	12					
	80						4					
	100											
	125											
	160											
	200											
	225											
	250											
315												
400												
500												

Maximum number of cable glands

M	Side	
	A/B	C/D
12	10	11
16	5	5
20	4	4
25	2	2
32	1	1
40		
50		
63		
75		
85		

DIN rail	TS 35
Length (mm)	107
max. fitting length (mm)	65
External earth (mm ²)	16



Order no.	Product type	Dimensions H x W x D (mm)
05.12 12 09	AExe 05065	120 x 122 x 91
15.12 12 09	AExi 15065	120 x 122 x 91
25.12 12 09	AExe 05015	120 x 122 x 91

		1,5	2,5	4	6	10	16	25	35	50	70	95
		19	15	13	10	8	6					
		1	1	1	1	1	1					
x 	6											
	10	43										
	16	14	28	110								
	20	6	16	32								
	25		7	18	35							
	35			5	13	34						
	50				2	11	28					
	63					3	13					
	80						5					
	100											
	125											
	160											
	200											
	225											
	250											
315												
400												
500												

Maximum number of cable glands

M	Side	
	A/B	C/D
12	10	11
16	5	5
20	4	4
25	2	2
32	1	1
40		
50		
63		
75		
85		

DIN rail	TS 35
Length (mm)	107
max. fitting length (mm)	65
External earth (mm ²)	16



Aluminium Ex

Technical details



Order no.	Product type	Dimensions H x W x D (mm)
05.12 22 08	AExe 05070	120 x 220 x 81
15.12 22 08	AExi 15070	120 x 220 x 81
25.12 22 08	AExe 05020	120 x 220 x 81

		1,5	2,5	4	6	10	16	25	35	50	70	95
		42	34	29	21	17	14					
		1	1	1	1	1	1					
x A	6											
	10	42										
	16	14	28	111								
	20	6	16	32								
	25		8	18	35							
	35			5	13	34						
	50				2	11	28					
	63					3	13					
	80						5					
	100											
	125											
	160											
	200											
	225											
	250											
	315											
	400											
500												

Maximum number of cable glands

M	Side	
	A/B	C/D
12	30	11
16	12	6
20	12	4
25	5	2
32	3	1
40		
50		
63		
75		
85		

DIN rail	TS 35
Length (mm)	205
max. fitting length (mm)	164,5
External earth (mm ²)	16



Order no.	Product type	Dimensions H x W x D (mm)
05.12 22 09	AExe 05075	120 x 220 x 91
15.12 22 09	AExi 15075	120 x 220 x 91
25.12 22 09	AExe 05025	120 x 220 x 91

		1,5	2,5	4	6	10	16	25	35	50	70	95
		42	34	29	21	17	14					
		1	1	1	1	1	1					
x A	6											
	10	45										
	16	15	30	118								
	20	6	17	34								
	25		8	19	37							
	35			5	14	36						
	50				2	11	30					
	63					4	14					
	80						5					
	100											
	125											
	160											
	200											
	225											
	250											
	315											
	400											
500												

Maximum number of cable glands

M	Side	
	A/B	C/D
12	34	11
16	15	6
20	14	4
25	6	2
32	4	1
40		
50		
63		
75		
85		

DIN rail	TS 35
Length (mm)	205
max. fitting length (mm)	164,5
External earth (mm ²)	16



Aluminium Ex

Technical details



Order no.	Product type	Dimensions H x W x D (mm)
05.12 36 08	AExe 05080	120 x 360 x 81
15.12 36 08	AExi 15080	120 x 360 x 81
25.12 36 08	AExe 05030	120 x 360 x 81

		1,5	2,5	4	6	10	16	25	35	50	70	95
		76	61	51	39	31	26					
		1	1	1	1	1	1					
x 	6											
	10	43										
	16	14	28	112								
	20	6	16	32								
	25		8	18	35							
	35			5	13	34						
	50				2	11	28					
	63					3	13					
	80						5					
	100											
	125											
	160											
	200											
	225											
	250											
	315											
400												
500												

Maximum number of cable glands

M	Side	
	A/B	C/D
12	58	11
16	26	5
20	24	4
25	10	2
32	7	1
40		
50		
63		
75		
85		

DIN rail	TS 35
Length (mm)	343
max. fitting length (mm)	305
External earth (mm ²)	16



Order no.	Product type	Dimensions H x W x D (mm)
05.14 14 09	AExe 05085	140 x 140 x 91
15.14 14 09	AExi 15085	140 x 140 x 91
25.14 14 09	AExe 05035	140 x 140 x 91

		1,5	2,5	4	6	10	16	25	35	50	70	95
		23	19	16	12	9	8	6				
		1	1	1	1	1	1	1				
x 	6											
	10	45										
	16	15	30	117								
	20	6	17	34								
	25		8	19	37							
	35			5	14	36						
	50				2	11	30					
	63					4	14	49				
	80						5	15				
	100							6				
	125											
	160											
	200											
	225											
	250											
	315											
400												
500												

Maximum number of cable glands

M	Side	
	A/B	C/D
12	18	12
16	8	6
20	8	4
25	3	2
32	2	1
40		
50		
63		
75		
85		

DIN rail	TS 35
Length (mm)	126
max. fitting length (mm)	86
External earth (mm ²)	25



Aluminium Ex

Technical details



Order no.	Product type	Dimensions H x W x D (mm)
05.14 20 09	AExe 05090	140 x 200 x 91
15.14 20 09	AExi 15090	140 x 200 x 91
25.14 20 09	AExe 05040	140 x 200 x 91

		1,5	2,5	4	6	10	16	25	35	50	70	95															
		38	30	25	19	15	13	10																			
		1	1	1	1	1	1	1																			
x A	6	Green						Grey																			
	10	48	Green						Grey																		
	16	16	32	125	Green						Grey																
	20	6	18	36	Green						Grey																
	25	9		20	39	Green						Grey															
	35	6			15	38	Green						Grey														
	50	2				12	31	Green						Grey													
	63	4					14	52	Green						Grey												
	80	5						16	Green						Grey												
	100	7							Green						Grey												
	125	7								Green						Grey											
	160	7									Green						Grey										
	200	7										Green						Grey									
	225	7											Green						Grey								
	250	7												Green						Grey							
	315	7													Green						Grey						
	400	7														Green						Grey					
500	7															Green						Grey					

Maximum number of cable glands

M	Side	
	A/B	C/D
12	28	12
16	12	6
20	12	4
25	5	2
32	3	1
40		
50		
63		
75		
85		

DIN rail	TS 35
Length (mm)	186
max. fitting length (mm)	140
External earth (mm ²)	25



Order no.	Product type	Dimensions H x W x D (mm)
05.16 16 09	AExe 05095	160 x 160 x 91
15.16 16 09	AExi 15095	160 x 160 x 91
25.16 16 09	AExe 05045	160 x 160 x 91

		1,5	2,5	4	6	10	16	25	35	50	70	95															
		28	23	19	14	11	9	7	7																		
		1	1	1	1	1	1	1	1																		
x A	6	Green						Grey																			
	10	48	Green						Grey																		
	16	16	32	125	Green						Grey																
	20	6	18	36	Green						Grey																
	25	9		20	39	Green						Grey															
	35	6			15	38	Green						Grey														
	50	2				12	31	Green						Grey													
	63	4					14	52	Green						Grey												
	80	5						16	58	Green						Grey											
	100	7							15	Green						Grey											
	125	6								Green						Grey											
	160	6									Green						Grey										
	200	6										Green						Grey									
	225	6											Green						Grey								
	250	6												Green						Grey							
	315	6													Green						Grey						
	400	6														Green						Grey					
500	6															Green						Grey					

Maximum number of cable glands

M	Side	
	A/B	C/D
12	26	16
16	12	8
20	9	6
25	5	3
32	3	2
40	2	1
50	2	
63		
75		
85		

DIN rail	TS 35
Length (mm)	144
max. fitting length (mm)	105
External earth (mm ²)	16



Aluminium Ex

Technical details



Order no.	Product type	Dimensions H x W x D (mm)
05.16 26 09	AExe 05100	160 x 260 x 91
15.16 26 09	AExi 15100	160 x 260 x 91
25.16 26 09	AExe 05050	160 x 260 x 91

		1,5	2,5	4	6	10	16	25	35	50	70	95
		52	42	35	26	21	18	14	14			
		1	1	1	1	1	1	1	1			
x 	6											
	10	52										
	16	18	34	135								
	20	7	20	39								
	25		9	22	42							
	35			6	16	41						
	50				2	13	34					
	63					4	16	56				
	80						6	17	63			
	100							7	16			
	125								6			
	160											
	200											
	225											
	250											
	315											
400												
500												

Maximum number of cable glands

M	Side	
	A/B	C/D
12	50	16
16	24	8
20	17	6
25	10	3
32	5	2
40	3	1
50	3	
63		
75		
85		

DIN rail	TS 35
Length (mm)	245
max. fitting length (mm)	205
External earth (mm ²)	16



Order no.	Product type	Dimensions H x W x D (mm)
05.16 36 09	AExe 05105	160 x 360 x 91
15.16 36 09	AExi 15105	160 x 360 x 91
25.16 36 09	AExe 05055	160 x 360 x 91

		1,5	2,5	4	6	10	16	25	35	50	70	95
		76	61	51	39	31	26	21	21			
		1	1	1	1	1	1	1	1			
x 	6											
	10	53										
	16	18	35	138								
	20	7	20	40								
	25		9	22	43							
	35			6	17	42						
	50				2	13	35					
	63					4	16	58				
	80						6	18	64			
	100							7	17			
	125								6			
	160											
	200											
	225											
	250											
	315											
400												
500												

Maximum number of cable glands

M	Side	
	A/B	C/D
12	72	16
16	36	8
20	24	6
25	15	3
32	7	2
40	5	1
50	4	
63		
75		
85		

DIN rail	TS 35
Length (mm)	343
max. fitting length (mm)	305
External earth (mm ²)	16



Aluminium Ex

Technical details



Order no.	Product type	Dimensions H x W x D (mm)
05.16 56 09	AExe 05110	160 x 560 x 91
15.16 56 09	AExi 15110	160 x 560 x 91
25.16 56 09	AExe 05060	160 x 560 x 91

		1,5	2,5	4	6	10	16	25	35	50	70	95
		123	100	83	63	50	42	34	34			
		1	1	1	1	1	1	1	1			
x A	6											
	10	53										
	16	18	35	138								
	20	7	20	40								
	25		9	22	43							
	35			6	17	42						
	50				2	13	35					
	63					4	16	58				
	80						6	18	64			
	100							7	17			
	125								6			
	160											
	200											
	225											
	250											
	315											
	400											
500												

Maximum number of cable glands



M	Side	
	A/B	C/D
12	104	16
16	58	8
20	40	6
25	24	3
32	12	2
40	8	1
50	6	
63		
75		
85		

DIN rail	TS 35
Length (mm)	543
max. fitting length (mm)	505
External earth (mm ²)	16



Order no.	Product type	Dimensions H x W x D (mm)
05.18 18 10	AExe 05115	180 x 180 x 101
15.18 18 10	AExi 15115	180 x 180 x 101
25.18 18 10	AExe 05065	180 x 180 x 101

		1,5	2,5	4	6	10	16	25	35	50	70	95
		33	26	22	17	13	11	9	9			
		1	1	1	1	1	1	1	1			
x A	6											
	10	54										
	16	18	36	139								
	20	7	21	40								
	25		10	23	44							
	35			6	17	43						
	50				2	14	35					
	63					4	16	58				
	80						6	18	65			
	100							7	17			
	125								7			
	160											
	200											
	225											
	250											
	315											
	400											
500												

Maximum number of cable glands



M	Side	
	A/B	C/D
12	30	20
16	15	9
20	11	8
25	6	3
32	3	2
40	2	2
50	2	
63		
75		
85		

DIN rail	TS 35
Length (mm)	166
max. fitting length (mm)	126
External earth (mm ²)	16



Aluminium Ex

Technical details



Order no.	Product type	Dimensions H x W x D (mm)
05.18 28 10	AExe 05120	180 x 280 x 101
15.18 28 10	AExi 15125	230 x 100 x 111
25.18 28 10	AExe 05070	180 x 280 x 101

		1,5	2,5	4	6	10	16	25	35	50	70	95
		57	46	38	29	23	19	15	15			
		1	1	1	1	1	1	1	1			
x 	6											
	10	58										
	16	20	38	150								
	20	8	22	43								
	25		10	24	47							
	35			7	18	46						
	50				2	15	38					
	63					5	17	63				
	80						6	19	70			
	100							8	18			
	125								7			
	160											
	200											
	225											
	250											
	315											
400												
500												

Maximum number of cable glands

M	Side	
	A/B	C/D
12	52	22
16	26	10
20	18	8
25	11	4
32	5	2
40	4	2
50	3	
63		
75		
85		

DIN rail	TS 35
Length (mm)	264
max. fitting length (mm)	221.5
External earth (mm ²)	16



Order no.	Product type	Dimensions H x W x D (mm)
05.23 10 11	AExe 05125	230 x 100 x 111
15.23 10 11	AExi 15120	180 x 280 x 101
25.23 10 11	AExe 05075	230 x 100 x 111

		1,5	2,5	4	6	10	16	25	35	50	70	95
		45	36	30	23							
		1	1	1	1							
x 	6											
	10	47										
	16	16	31	123								
	20	6	18	35								
	25		8	20	39							
	35			6	15							
	50				2							
	63											
	80											
	100											
	125											
	160											
	200											
	225											
	250											
	315											
400												
500												

Maximum number of cable glands

M	Side	
	A/B	C/D
12	15	45
16	8	18
20	6	17
25	3	8
32	2	5
40	1	3
50	1	2
63		2
75		
85		

DIN rail	TS 35
Length (mm)	214
max. fitting length (mm)	172
External earth (mm ²)	6



Aluminium Ex

Technical details



Order no.	Product type	Dimensions H x W x D (mm)
05.23 20 11	AExe 05130	232 x 202 x 111
15.23 20 11	AExi 15130	232 x 202 x 111
25.23 20 11	AExe 05080	232 x 202 x 111

		1,5	2,5	4	6	10	16	25	35	50	70	95											
		76	62	52	38	15	13	10	10														
		2	2	2	2	1	1	1	1														
x A	6																						
	10												62										
	16												21	41	160								
	20												8	24	46								
	25													11	26	50							
	35														7	19	49						
	50															2	16	40					
	63																5	19	67				
	80																	7	21	75			
	100																		9	19			
	125																			8			
	160																						
	200																						
	225																						
	250																						
	315																						
	400																						
500																							

Maximum number of cable glands

M	Side	
	A/B	C/D
12	45	45
16	22	18
20	18	17
25	8	8
32	6	5
40	3	3
50	2	2
63	2	2
75		
85		

DIN rail	TS 35
Length (mm)	186
max. fitting length (mm)	140
External earth (mm ²)	16



Order no.	Product type	Dimensions H x W x D (mm)
05.23 20 18	AExe 05135	232 x 202 x 181
15.23 20 18	AExi 15135	232 x 202 x 181
25.23 20 18	AExe 05085	232 x 202 x 181

		1,5	2,5	4	6	10	16	25	35	50	70	95											
		76	62	52	38	15	13	10	10	8													
		2	2	2	2	1	1	1	1	1													
x A	6																						
	10												82										
	16												28	54	211								
	20												11	31	61								
	25													15	34	67							
	35														10	26	65						
	50															3	21	54					
	63																7	25	88				
	80																	9	27	99			
	100																		12	26			
	125																			10	26		
	160																				9		
	200																						
	225																						
	250																						
	315																						
	400																						
500																							

Maximum number of cable glands

M	Side	
	A/B	C/D
12	90	81
16	42	36
20	33	33
25	18	16
32	10	9
40	6	6
50	5	5
63	4	4
75		
85		

DIN rail	TS 35
Length (mm)	186
max. fitting length (mm)	140
External earth (mm ²)	35



Aluminium Ex

Technical details



Order no.	Product type	Dimensions H x W x D (mm)
05.23 28 11	AExe 05140	230 x 280 x 111
15.23 28 11	AExi 15140	230 x 280 x 111
25.23 28 11	AExe 05090	230 x 280 x 111

Maximum number of cable glands

M	Side	
	A/B	C/D
12	70	45
16	32	18
20	24	17
25	12	8
32	9	5
40	4	3
50	3	2
63	3	2
75		
85		

		1,5	2,5	4	6	10	16	25	35	50	70	95
		114	92	76	58	46	19	15	15			
		2	2	2	2	2	1	1	1			
x A	6											
	10	67										
	16	23	44	173								
	20	9	26	50								
	25		12	28	54							
	35			8	21	53						
	50				3	17	44					
	63					5	20	72				
	80						7	22	81			
	100							9	21			
	125								8			
	160											
	200											
	225											
	250											
	315											
400												
500												

DIN rail	TS 35
Length (mm)	264
max. fitting length (mm)	220
External earth (mm ²)	16



Order no.	Product type	Dimensions H x W x D (mm)
05.23 33 11	AExe 05145	230 x 330 x 111
15.23 33 11	AExi 15145	230 x 330 x 111
25.23 33 11	AExe 05095	230 x 330 x 111

Maximum number of cable glands

M	Side	
	A/B	C/D
12	84	45
16	42	18
20	30	17
25	15	8
32	11	5
40	5	3
50	4	2
63	4	2
75		
85		

		1,5	2,5	4	6	10	16	25	35	50	70	95
		138	110	92	70	56	23	19	19			
		2	2	2	2	2	1	1	1			
x A	6											
	10	69										
	16	23	45	178								
	20	9	26	51								
	25		12	29	56							
	35			8	22	54						
	50				3	18	45					
	63					6	21	74				
	80						8	23	83			
	100							10	22			
	125								9			
	160											
	200											
	225											
	250											
	315											
400												
500												

DIN rail	TS 35
Length (mm)	314
max. fitting length (mm)	270
External earth (mm ²)	16



Aluminium Ex

Technical details



Order no.	Product type	Dimensions H x W x D (mm)
05.23 33 18	AExe 05150	230 x 330 x 181
15.23 33 18	AExi 15150	230 x 330 x 181
25.23 33 18	AExe 05100	230 x 330 x 181

		1,5	2,5	4	6	10	16	25	35	50	70	95
		138	110	92	70	56	23	19	19	14		
		2	2	2	2	2	1	1	1	1		
x A	6											
	10	88										
	16	30	59	228								
	20	12	34	66								
	25		16	37	72							
	35			11	28	70						
	50				4	23	58					
	63					7	27	96				
	80						10	30	107			
	100							13	28			
	125								11	28		
	160									10		
	200											
	225											
	250											
	315											
400												
500												

Maximum number of cable glands

M	Side	
	A/B	C/D
12	165	81
16	77	36
20	60	33
25	30	16
32	18	9
40	11	6
50	8	5
63	8	4
75		
85		

DIN rail	TS 35
Length (mm)	314
max. fitting length (mm)	270
External earth (mm ²)	35



Order no.	Product type	Dimensions H x W x D (mm)
05.23 40 11	AExe 05155	230 x 400 x 111
15.23 40 11	AExi 15155	230 x 400 x 111
25.23 40 11	AExe 05105	230 x 400 x 111

		1,5	2,5	4	6	10	16	25	35	50	70	95
		170	138	116	86	70	29	23	23			
		2	2	2	2	2	1	1	1			
x A	6											
	10	70										
	16	24	47	182								
	20	10	27	52								
	25		13	30	57							
	35			8	22	56						
	50				3	18	46					
	63					6	21	76				
	80						8	24	85			
	100							10	22			
	125								9			
	160											
	200											
	225											
	250											
	315											
400												
500												

Maximum number of cable glands

M	Side	
	A/B	C/D
12	103	45
16	50	18
20	39	17
25	20	8
32	14	5
40	6	3
50	5	2
63	5	2
75		
85		

DIN rail	TS 35
Length (mm)	381
max. fitting length (mm)	340
External earth (mm ²)	16



Aluminium Ex

Technical details



Order no.	Product type	Dimensions H x W x D (mm)
05.23 40 23	AExe 05160	230 x 400 x 225
15.23 40 23	AExi 15160	230 x 400 x 225
25.23 40 23	AExe 05110	230 x 400 x 225

		1,5	2,5	4	6	10	16	25	35	50	70	95
		170	138	116	86	70	29	23	23	18		
		2	2	2	2	2	1	1	1	1		
x 	6											
	10	102										
	16	35	67	263								
	20	14	39	76								
	25		18	43	83							
	35			12	32	81						
	50				4	26	67					
	63					9	31	110				
	80						12	34	123			
	100							15	32			
	125								13	33		
	160									11		
	200											
	225											
	250											
	315											
	400											
500												

Maximum number of cable glands

M	Side	
	A/B	C/D
12	240	108
16	122	48
20	100	44
25	54	21
32	30	13
40	18	9
50	15	6
63	12	5
75		
85		

DIN rail	TS 35
Length (mm)	381
max. fitting length (mm)	340
External earth (mm ²)	35



Order no.	Product type	Dimensions H x W x D (mm)
05.23 60 11	AExe 05165	230 x 600 x 111
15.23 60 11	AExi 15165	230 x 600 x 111
25.23 60 11	AExe 05115	230 x 600 x 111

		1,5	2,5	4	6	10	16	25	35	50	70	95
		266	214	180	136	54	45	36	36			
		2	2	2	2	1	1	1	1			
x 	6											
	10	72										
	16	24	47	185								
	20	10	28	54								
	25		13	30	58							
	35			9	23	57						
	50				3	18	47					
	63					6	22	78				
	80						8	24	87			
	100							10	23			
	125								9			
	160											
	200											
	225											
	250											
	315											
	400											
500												

Maximum number of cable glands

M	Side	
	A/B	C/D
12	150	43
16	72	18
20	54	17
25	28	8
32	20	4
40	10	3
50	8	2
63	6	2
75		
85		

DIN rail	TS 35
Length (mm)	581
max. fitting length (mm)	540
External earth (mm ²)	16



Aluminium Ex

Technical details



Order no.	Product type	Dimensions H x W x D (mm)
05.31 40 11	AExe 05170	313 x 404 x 111
15.31 40 11	AExi 15170	313 x 404 x 111
25.31 40 11	AExe 05120	313 x 404 x 111

		1,5	2,5	4	6	10	16	25	35	50	70	95
		258	210	174	132	70	58	23	23			
		3	3	3	2	2	2	1	1			
x A	6											
	10	81										
	16	27	54	209								
	20	11	31	60								
	25		15	34	66							
	35			10	26	64						
	50				3	21	43					
	63					7	24	87				
	80						9	27	98			
	100							11	26			
	125								10			
	160											
	200											
	225											
	250											
	315											
	400											
500												

Maximum number of cable glands

M	Side	
	A/B	C/D
12	105	68
16	50	28
20	39	26
25	20	12
32	14	7
40	6	4
50	5	3
63	5	3
75		
85		

DIN rail	TS 35
Length (mm)	381
max. fitting length (mm)	340
External earth (mm ²)	16



Order no.	Product type	Dimensions H x W x D (mm)
05.31 40 14	AExe 05175	312 x 403 x 141
15.31 40 14	AExi 15175	312 x 403 x 141
25.31 40 14	AExe 05125	312 x 403 x 141

		1,5	2,5	4	6	10	16	25	35	50	70	95
		258	207	174	132	70	58	23	23	18	14	14
		3	3	3	2	2	2	1	1	1	1	1
x A	6											
	10	89										
	16	30	59	230								
	20	12	34	67								
	25		16	38	73							
	35			11	28	71						
	50				4	23	58					
	63					7	27	97				
	80						10	30	108			
	100							13	28			
	125								11	29		
	160									10	25	
	200										9	22
	225										3	12
	250											6
	315											
	400											
500												

Maximum number of cable glands

M	Side	
	A/B	C/D
12	147	95
16	70	43
20	55	32
25	28	18
32	17	10
40	12	7
50	7	4
63	6	3
75		
85		

DIN rail	TS 35
Length (mm)	381
max. fitting length (mm)	340
External earth (mm ²)	50



Aluminium Ex

Technical details



Order no.	Product type	Dimensions H x W x D (mm)
05.31 40 18	AExe 05180	313 x 404 x 181
15.31 40 18	AExi 15180	313 x 404 x 181
25.31 40 18	AExe 05130	313 x 404 x 181

		1,5	2,5	4	6	10	16	25	35	50	70	95	
		258	210	174	132	70	58	23	23	18	14	14	
		3	3	3	2	2	2	1	1	1	1	1	
x 	6												
	10	101											
	16	34	67	260									
	20	14	39	75									
	25		18	43	82								
	35			12	32	80							
	50				4	26	66						
	63					8	31	109					
	80						11	34	122				
	100							14	32				
	125								13	32			
	160									11	28		
	200										10	25	
	225											4	14
	250												7
	315												
	400												
	500												

Maximum number of cable glands

M	Side	
	A/B	C/D
12	205	122
16	98	54
20	78	51
25	40	24
32	22	15
40	15	9
50	11	6
63	8	6
75		
85		

DIN rail	TS 35
Length (mm)	381
max. fitting length (mm)	340
External earth (mm ²)	50



Order no.	Product type	Dimensions H x W x D (mm)
05.31 40 23	AExe 05185	313 x 404 x 227
15.31 40 23	AExi 15185	313 x 404 x 227
25.31 40 23	AExe 05135	313 x 404 x 227

		1,5	2,5	4	6	10	16	25	35	50	70	95	
		258	210	174	132	70	58	23	23	18	14	14	
		3	3	3	2	2	2	1	1	1	1	1	
x 	6												
	10	114											
	16	39	75	294									
	20	16	44	85									
	25		21	48	93								
	35			14	36	90							
	50				5	29	75						
	63					10	35	123					
	80						13	38	138				
	100							16	36				
	125								14	37			
	160									12	32		
	200										11	28	
	225											4	16
	250												8
	315												
	400												
	500												

Maximum number of cable glands

M	Side	
	A/B	C/D
12	246	162
16	126	72
20	100	68
25	54	33
32	30	20
40	18	12
50	15	9
63	12	8
75		
85		

DIN rail	TS 35
Length (mm)	381
max. fitting length (mm)	340
External earth (mm ²)	50



Aluminium Ex

Technical details



Order no.	Product type	Dimensions H x W x D (mm)
05.31 60 11	AExe 05190	310 x 600 x 111
15.31 60 11	AExi 15190	310 x 600 x 111
25.31 60 11	AExe 05140	310 x 600 x 111

		1,5	2,5	4	6	10	16	25	35	50	70	95
		399	321	270	204	108	90	36	36			
		3	3	3	2	2	2	1	1			
x A	6											
	10	85										
	16	29	56	220								
	20	12	33	64								
	25		15	36	69							
	35			10	27	68						
	50				4	22	56					
	63					7	26	92				
	80						10	29	103			
	100							12	27			
	125								11			
	160											
	200											
	225											
	250											
	315											
	400											
500												

Maximum number of cable glands



M	Side	
	A/B	C/D
12	150	68
16	76	28
20	60	24
25	30	12
32	20	7
40	10	4
50	8	3
63	6	3
75		
85		

DIN rail	TS 35
Length (mm)	581
max. fitting length (mm)	540
External earth (mm ²)	16



Order no.	Product type	Dimensions H x W x D (mm)
05.31 60 18	AExe 05195	310 x 600 x 181
15.31 60 18	AExi 15195	310 x 600 x 181
25.31 60 18	AExe 05145	310 x 600 x 181

		1,5	2,5	4	6	10	16	25	35	50	70	95
		399	321	270	204	108	90	36	36	28	22	22
		3	3	3	2	2	2	1	1	1	1	1
x A	6											
	10	104										
	16	36	69	269								
	20	15	40	78								
	25		19	44	85							
	35			13	33	83						
	50				5	27	68					
	63					9	32	113				
	80						12	35	126			
	100							15	33			
	125								13	34		
	160									11	30	
	200										10	26
	225										4	15
	250											8
	315											
	400											
500												

Maximum number of cable glands



M	Side	
	A/B	C/D
12	270	122
16	140	54
20	108	48
25	56	24
32	32	15
40	22	9
50	16	6
63	12	6
75		
85		

DIN rail	TS 35
Length (mm)	581
max. fitting length (mm)	540
External earth (mm ²)	50



Aluminium Ex

Technical details



Order no.	Product type	Dimensions H x W x D (mm)
05.60 60 20	AExe 05200	600 x 600 x 202
15.60 60 20	AExi 15200	600 x 600 x 202
25.60 60 20	AExe 05150	600 x 600 x 202

Maximum number of cable glands		
M	Side	
	A/B	C/D
12	270	270
16	140	140
20	108	108
25	56	56
32	32	32
40	22	22
50	16	16
63	12	12
75		
85		

	1,5	2,5	4	6	10	16	25	35	50	70	95	120	150	185	240	
	532	428	360	204	162	135	108	108	56	22	22	18	18	15	15	
	4	4	4	3	3	3	2	2	1	1	1	1	1	1	1	
 x A	6															
	10	142														
	16	49	95	368												
	20	20	55	107												
	25		26	60	116											
	35			18	45	113										
	50				6	37	94									
	63					12	43	154								
	80						16	48	173							
	100							20	45							
	125							2	18	46						
	160								16	41						
	200									14	35	109				
	225									5	20	42				
	250										10	26	54			
	315											5	15	32		
	400													7	22	
500															3	

DIN rail	TS 35
Length (mm)	575
max. fitting length (mm)	540
External earth (mm ²)	120



Aluminium Ex

Technical details

Order no.	b	h	t	b1	h1	t1	a
XX.06 10 03	98	64	34	91	57	28,5	14
XX.06 15 03	150	64	34	143	57	28,5	14
XX.08 13 06	125	72	80	117	72	51	9
XX.08 18 06	175	72	80	167	72	51	9
XX.08 25 05	250	242	52	45	72	45	15,5
XX.10 16 08	160	100	81	152	92	74	9,5
XX.10 20 08	200	100	81	192	92	74	9,5
XX.12 22 08	220	120	81	211	111	72	13
XX.12 22 09	220	120	91	211	111	82	13
XX.12 36 08	360	120	81	351	111	72	13
XX.14 20 09	200	140	91	191	131	82	13
XX.16 26 09	260	160	91	251	151	82	13
XX.16 36 09	360	160	91	351	151	82	13
XX.16 56 09	560	160	91	551	151	82	13
XX.18 28 10	280	180	101	271	171	92	13
XX.23 28 11	280	230	111	271	221	102	13
XX.23 33 11	330	230	111	320	220	102	13
XX.23 33 18	330	230	181	320	220	170	13
XX.23 40 11	400	230	111	390	220	102	13
XX.23 40 23	400	230	225	389	219	214	14
XX.23 60 11	600	230	111	588	218	100	14
XX.31 40 11	404	313	111	394	303	101	13
XX.31 40 14	403	312	141	391	300	129	14
XX.31 40 18	404	313	181	394	303	169	14
XX.31 40 23	404	313	227	391	300	216	14
XX.31 60 11	600	310	111	588	298	99	14
XX.31 60 18	600	310	181	588	298	169	14

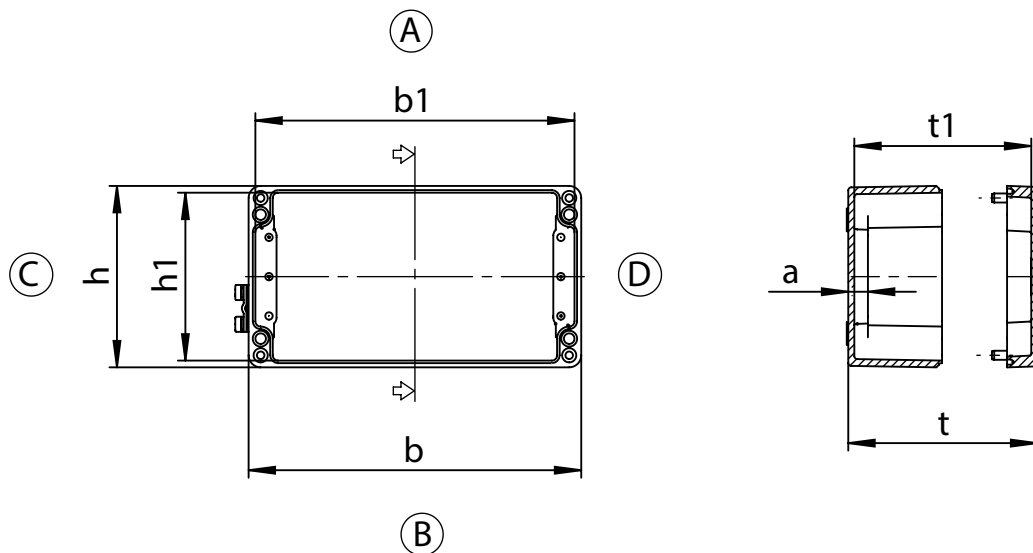

For detailed drawings visit www.rose-pw.de



Aluminium Ex

Technical details

Order no.	b	h	t	b1	h1	t1	a
XX.23 10 11	100	230	111	89	220	101	14
XX.23 20 11	202	232	111	192	222	102	13
XX.23 20 18	202	232	181	192	222	170	14

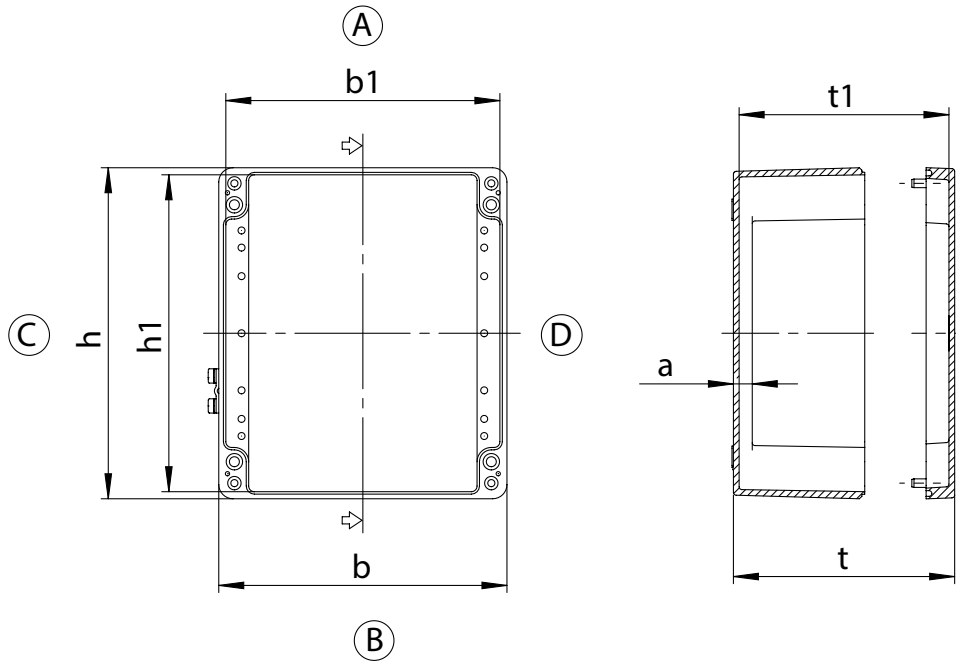

Order no.	b	h	t	b1	h1	t1	a
XX.06 06 03	58	64	34	51	57	28,5	14
XX.08 08 06	75	72	80	67	72	51	9
XX.10 10 08	100	100	81	92	92	74	9,5
XX.12 12 08	122	120	81	113	111	72	13
XX.12 12 09	122	120	91	113	111	82	13
XX.14 14 09	140	140	91	131	131	82	13
XX.16 16 09	160	160	91	151	151	82	13
XX.18 18 10	180	180	101	171	171	92	13
XX.60 60 20	600	600	202,5	588	588	189	17

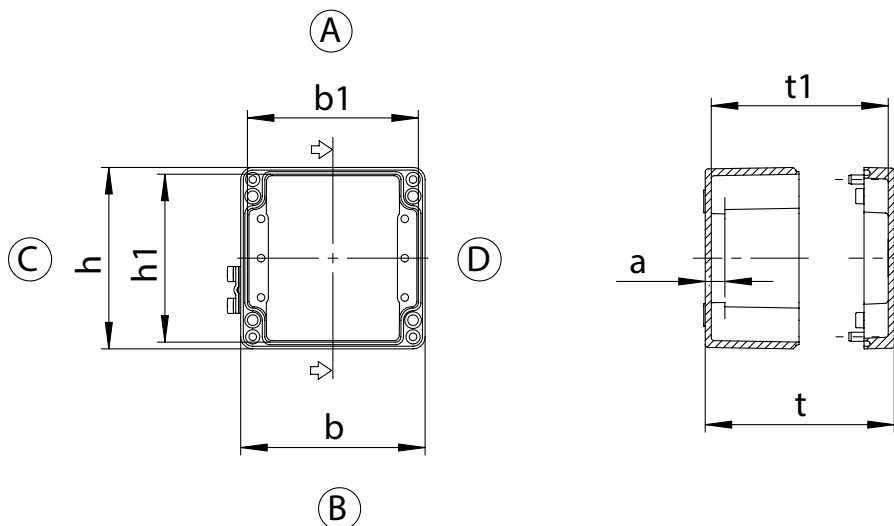

For detailed drawings visit www.rose-pw.de

